

# How to Reset the Hour Counter After Periodic Maintenance is Performed

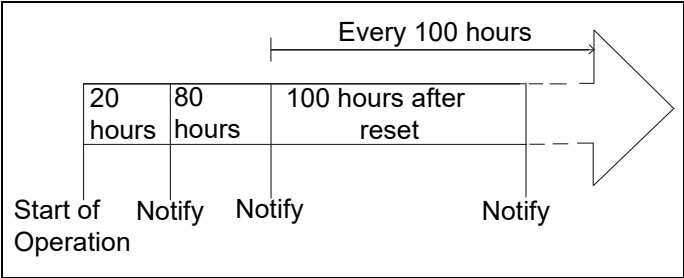

## INTRODUCTION

The hour counter on certain Honda outboard motors counts the number of operating hours since the last time periodic maintenance was performed and the hour counter was reset. When the next periodic maintenance is due, the engine notifies the NMEA 2000® network, and a maintenance indication is displayed on an NMEA 2000® compatible device.



Periodic maintenance is required when either the operating hours or the time since last maintenance reaches the prescribed limit. Therefore, periodic maintenance may be required before the hour counter generates a maintenance indication.

Reset the hour counter whenever maintenance is performed, whether based on the time interval or the number of operating hours.

The owner's manual that was provided with certain Honda outboards may not have included instructions on how to reset the hour counter after performing periodic maintenance. The table shown to the right lists the Honda outboard models and serial number ranges that use the operating hour notification system.

Choose the appropriate procedure below to reset the hour counter:

### Resetting the counter for outboards without iST:

For outboards without iST (intelligent shift and throttle), see [page 2](#) to reset the hour counter.

### Resetting the counter for outboards with iST:

- BF250A model  
See [page 3](#) to reset the hour counter.
- BF115J - BF140A - BF150D - BF200D - BF225D - BF250D models  
See [page 5](#) to reset the hour counter.

Model	Serial Number Range
BF40D	BBDJ-1104290 ~ subsequent
BF50D	BBEJ-1109247 ~ subsequent
BF60A	BBFJ-1103657 ~ subsequent
BFP60A	BBFJ-8000001 ~ subsequent
BF75D	BBAJ-1200002 ~ subsequent
BF90D	BBCJ-1300006 ~ subsequent
BF100A	BBMJ-1000014 ~ subsequent
BF115D	BBHJ-1102827 ~ subsequent
BF115J	BBWJ-1000001 ~ subsequent
BF135A	BARJ-1401219 ~ subsequent
	BASJ-1400161 ~ subsequent
BF140A	BBUJ-1000001 ~ subsequent
	BBUJ-8000001 ~ subsequent
BF150A	BANJ-1404972 ~ subsequent
	BAPJ-1400580 ~ subsequent
BF150D	BBTJ-1000001 ~ subsequent
	BBTJ-8000001 ~ subsequent
BF200A	BAEJ-1800381 ~ subsequent
	BAFJ-1800048 ~ subsequent
BF200D	BBRJ-1000001 ~ subsequent
	BBRJ-8000001 ~ subsequent
BF225A	BAGJ-1800815 ~ subsequent
	BAHJ-1800330 ~ subsequent
BF225D	BBPJ-1000001 ~ subsequent
	BBPJ-8000001 ~ subsequent
BF250A	BBJJ-1003406 ~ subsequent
	BBJJ-8000852 ~ subsequent
BF250D	BBNJ-1000001 ~ subsequent
	BBNJ-8000001 ~ subsequent

## RESETTING THE COUNTER FOR OUTBOARDS WITHOUT iST

1. Turn the ignition switch OFF, and then remove the emergency stop switch clip from the emergency stop switch.



2. Move the shift lever(s) into the forward or reverse position.

**Note:**

Vessels with more than one outboard motor must have all shift levers in gear. The hour counter cannot be reset on any outboard that is not in gear. For example, if the hour counter is reset when the starboard engine is in gear but the port engine is not, the starboard engine will be reset and the port engine will not be reset.

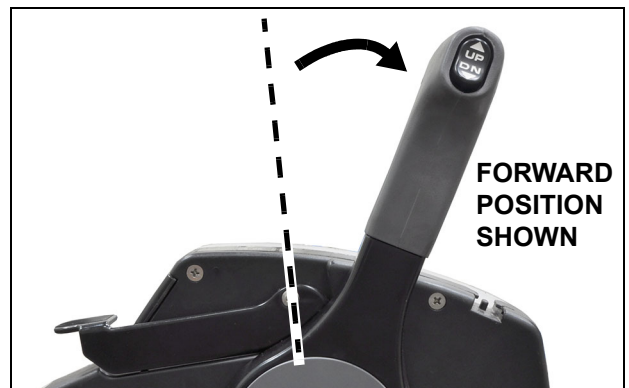

3. Turn the ignition switch to the ON position but do not start the engine. The buzzer will sound once.



4. Press the emergency stop switch button five times within 20 seconds. The buzzer will sound once indicating the hour counter has been reset.



## RESETTING THE COUNTER FOR OUTBOARDS WITH iST

### BF250A model

1. Turn the ignition switch to the ON position, but do not start the engine(s).



2. Move the shift lever(s) into the forward or reverse position.

**Note:**

Vessels with more than one outboard motor must have all shift levers in gear.

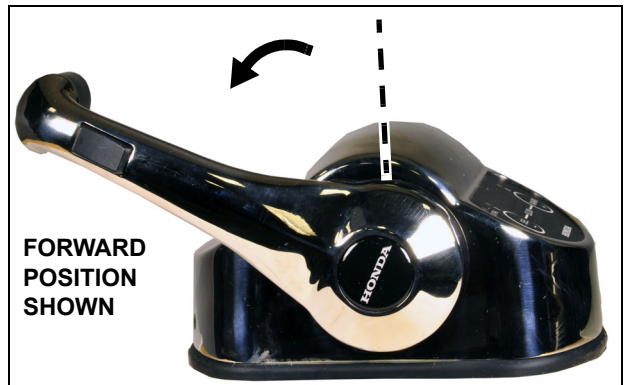

3. Turn the ignition switch to the OFF position, and then manually spin each propeller to ensure the engine is in gear.

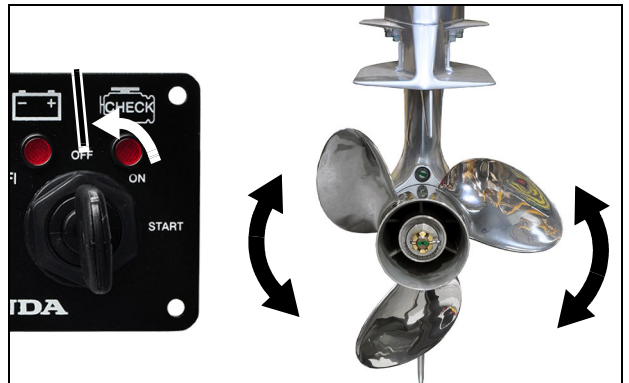

4. Remove the emergency stop switch clip from the emergency stop switch.



5. Remove the fuse from the iST DC power harness. Refer to the iST owner's manual supplied with the outboard for the location of the fuse.

**Note:**

If you do not have the appropriate iST owner's manual, an electronic copy can be found by visiting [marine.honda.com](https://marine.honda.com) and then selecting Service & Support> Owner's Manuals.

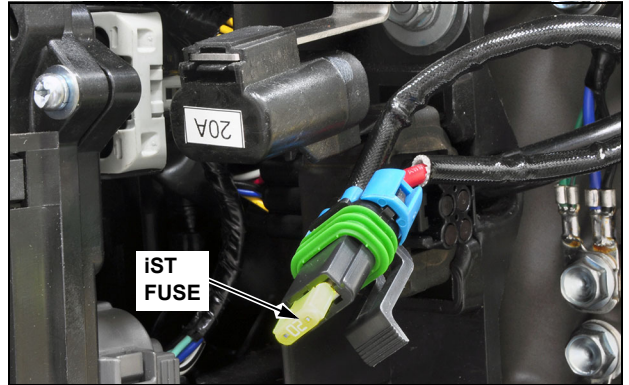

6. Turn the ignition switch to the ON position but do not start the engine. The buzzer will sound once.
7. Press the emergency stop switch button five times within 20 seconds. The buzzer will sound once indicating the hour counter has been reset.



8. Return the shift lever(s) to the neutral position, and then turn the ignition switch(es) OFF.

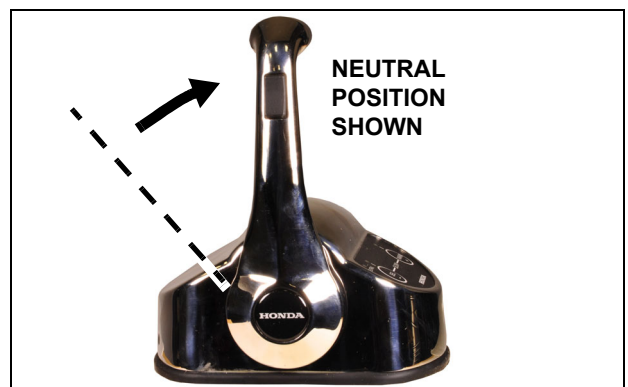

9. Reinstall the fuse into the iST DC power harness.

10. Turn the ignition switch(es) to the ON position and ensure the engines shift back to neutral (the propellers should turn freely by hand).

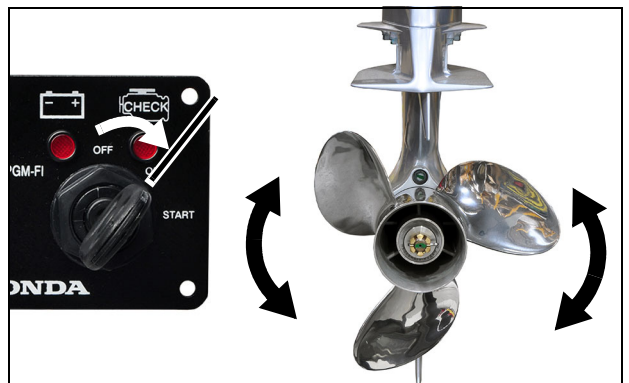

## BF115J • BF140A • BF150D • BF200D • BF225D • BF250D models

1. Turn the ignition switch to the ON position, but do not start the engine(s). A buzzer will sound two times.

Wait at least one second before performing step two.



2. Move the shift lever(s) into the forward or reverse position.

Note:

Vessels with more than one outboard motor must have **ALL** shift levers in gear.



3. Cycle the ignition switch to the OFF position, and then back to the ON position. The buzzer will sound two times.





4. Perform this sequence five times within 20 seconds or until the buzzer sounds one time:

Remove the emergency stop switch clip from the emergency stop switch, and then reinsert the stop switch clip onto the switch.

The buzzer should sound once indicating the hour counter has been reset.

If the buzzer did not sound and the hour counter did not reset, repeat these four steps again ensuring that you wait at least one second between performing steps one and two.

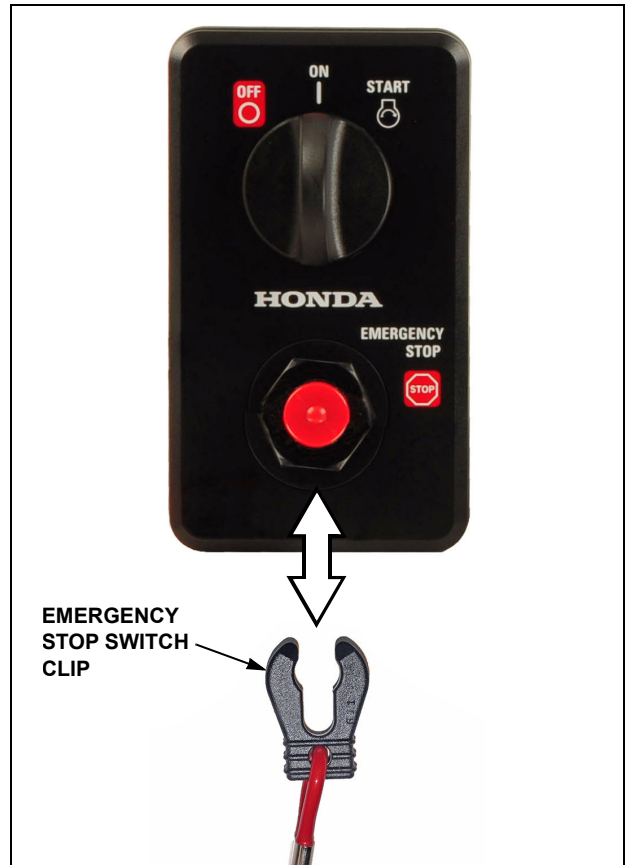

5. Return the shift lever(s) to the neutral position, and then turn the ignition switch(es) OFF.

