

## Inspecting Miimo's Blades

### Robotic Lawn Mower

Check the condition of Miimo's blades every week to keep them cutting at a high level of performance. When the blades become dull, they will not make clean cuts, and you may notice brown or white tips on the cut ends of the grass blades.

Typically, the lifetime of the blades is 160 hours of cutting time. Because the lifetime of the blades depends on grass condition and how much time Miimo mows, it may be necessary to change the blades sooner, especially during the spring season.

For example, if Miimo mows for 11.4 hours per day, every day, the lifetime of the blades may be 2 weeks. However, if Miimo only mows for 2.6 hours per day, every day, the lifetime of the blades may be 2 months.

Follow the information below to keep Miimo's blade system performing optimally. If you are not comfortable inspecting the blades following the information below, contact an authorized Honda Power Equipment dealer for assistance. Visit [powerequipment.honda.com](http://powerequipment.honda.com) to find a dealer near you, or call us at 770-497-6400, option 6.

### Before Inspection

#### ⚠ WARNING

The blades are extremely sharp, and can cut you severely. Do not touch the blades with your bare hands. Put on a pair of work gloves before inspecting Miimo.

- Press the manual STOP button, turn Miimo OFF, and then remove Miimo from the docking station.
- Hold Miimo against a wall for support.

### Inspection

Check the blades, blade nuts, and blade disc for damage or wear following the information below.

#### Blades

Visually inspect the blade edges and holes for wear, cracks, or bends, and replace them if necessary.

While mowing, the blade holes will widen due to abrasion against the blade nuts, and there is a danger that the blades could detach from the blade disc.

Measure the blade length, as shown, while the blade is in the 6 o'clock position.

If the blade length measures greater than 25.2 mm (0.99 in) from the blade disc to the end of the blade, the blade holes and/or blade nuts ([page 2](#)) may be worn, and should be replaced.

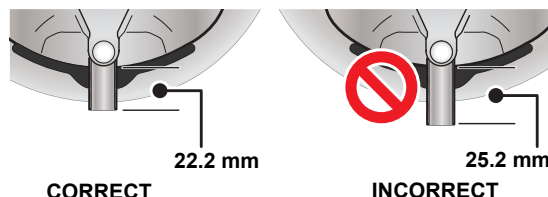
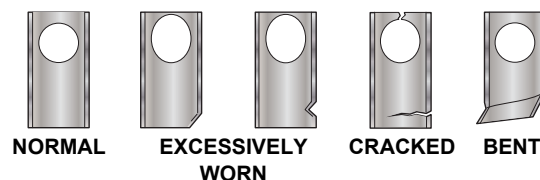
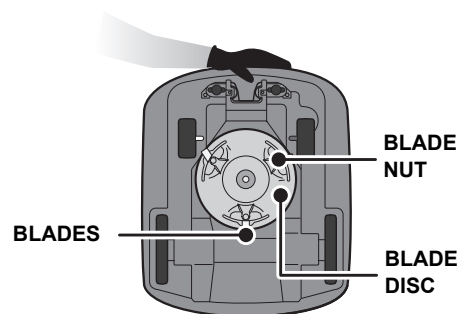
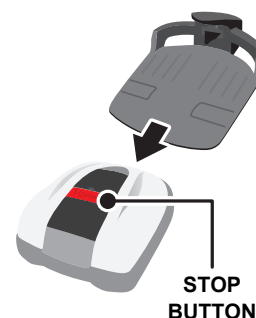

### **Blade Nuts**

Rotate the nuts with your fingers to check that they are not loose. If they are loose, tighten them to the specified torque. Refer to the Owner's Manual for the procedure on tightening the nuts.

**TORQUE: 3.2 - 4.4 ft-lb (38.4 - 52.8 in•lb, 4.4 - 6.0 N•m)**

Check for abrasions on the shoulders of the blade nuts. While mowing, the shoulders of the nuts decrease in size due to abrasion against the blades. Replace the blades and nuts if this occurs.

If you are unsure if there are any abrasions on the shoulders, removal of the blade nut and blade may be necessary for further inspection.

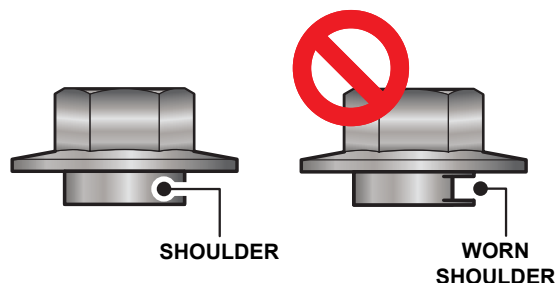

### **Blade Disc**

Rotate the blade disc and visually check it for warping. If it is warped, consult an authorized Honda Power Equipment dealer.

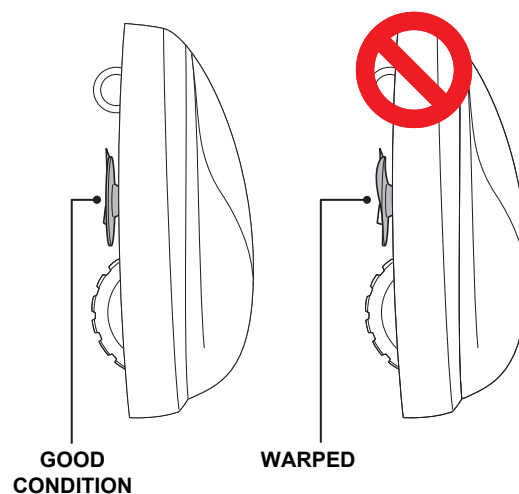

### **⚠ WARNING**

The blades are extremely sharp, and can cut you severely.  
Do not touch the blades with your bare hands.  
Put on a pair of work gloves before inspecting Miimo.